

Crowne Plaza Tulsa, Oklahoma

Crowne Plaza understands everything that goes into planning and hosting a meeting. That's why we've developed the Meeting SuccessSM program. Available at over 111 hotels in North America, Meeting Success recognizes the individual needs of each meeting planner, offers unique and special program choices and assures customer satisfaction.

LOCATION

- Conveniently located in the heart of Tulsa's art deco, business, entertainment and cultural district. Adjacent to the Performing Arts Center, five blocks from the Tulsa Convention Center, two blocks from the new BOK Center and just 10 minutes from Tulsa International Airport.



ACCOMMODATIONS

- 462 spacious guest rooms, including five luxurious suites.
- Guest rooms feature the new Sleep AdvantageTM program.
- Club Level & Club Lounge
- Wireless internet access.
- In-room movies. (HBO & Pay Per View)
- In-room coffee makers.

GUEST AMENITIES

- Indoor/outdoor heated swimming pool.
- 24-hour fitness center.
- On-site Elements Spa.
- Starbucks Cafe
- Elegant gift boutique
- Express check-out.
- Safe deposit/security storage
- 24-hour Business Center.
- Same-day dry cleaning & laundry.
- Enterprise Car Rental
- Free shuttle service to and from airport.
- Coin-operated guest laundry facility on site.
- Covered Valet & Self parking.



BUSINESS SERVICES

- Fax, copy, mailing, overnight mail and secretarial services available. In-house audiovisual equipment and a trained staff to assist you.

DINING AND ENTERTAINMENT

- Enjoy the casual elegance of our Daily Grill restaurant serving breakfast lunch and dinner, or relax in our lobby lounge and select from the light menu. For entertainment, walk to the Blue Dome and Brady Districts for a wide array of night clubs and restaurants. Take a stroll on Cherry Street, Brookside or Utica Square for unique shopping, bistros, restaurants and nightly entertainment all within five to ten minutes of the Crowne Plaza Tulsa.
- Daily Grill Patio / Starbucks Cafe Patio

DIRECTIONS

- From Tulsa International Airport, take I-244 West. Take the First St. exit, left on Cheyenne and left on Second St. Crowne Plaza is between Boulder and Cincinnati.

ROOM TYPES

• Rooms:	460
• Double/Double	265
• King	190
• Parlors	5

MEETING SUCCESS AT CROWNE PLAZA

- **2-Hour Response Guarantee** – when you contact us, we'll return your initial inquiry within 2 hours, guaranteed, and provide a proposal by the next business day.
- **Crowne Meetings Director** – with Crowne Plaza you'll receive expert help from our Crowne Meetings Director from the time you start planning to the time you leave.
- **Daily Meeting Debrief** – receive a complete itemization of all accounting for that day's expenditures to help you manage your budget.
- Meeting space and dimensions on reverse side.

cptulsaahotel.com



MEETING FACILITIES

- Over 38,000 sq. ft. of space is available to meet your agenda, featuring two elegantly decorated ballrooms with pre-function areas, each accommodating 1,200 to 1,400 guests. Also included are 10 other meeting rooms and two multi-use studios. State-of-the-art audio-visual equipment and technical service are available on site.
- Customize your next meeting with a free perk or amenity. Be sure to ask for Meeting OptionsSM
- Priority Club[®] points or miles are available to meeting attendees with qualifying rates.

	Square Feet	Classroom	Board Room	Reception	Banquet	U-Shape	Theater	Ceiling Height	Length	Width
Tulsa Ballroom	9908	700	-	1100	1100	-	1400	15'	155'	64'
South	4510	300	80	400	400	80	450	15'	70'	64'
Central	2741	180	50	300	250	40	260	15'	43'	64'
North	2656	180	50	300	250	40	300	15'	42'	64'
Foyer	5000	-	-	400	-	-	-	14'	-	-
Oklahoma Room	1419	90	50	100	100	40	125	12.5'	43'	33'
South or North	710	40	25	50	50	25	79	12.5'	21.6'	33'
Promenade Ballroom	9428	650	-	1000	800	-	1200	15'	177'	53'
Salon A	2130	150	40	200	150	30	240	15'	43'	53'
Salon B or C	2289	180	50	220	180	40	280	15'	43'	53'
Salon D	2720	200	70	280	220	50	380	15'	51'	53'
Foyer	6000	-	-	-	-	-	-	-	-	-
Directors Row 1 & 2	406	18	16	40	30	10	40	10'	23'	18'
Directors Row 3, 4 & 5	541	30	18	40	30	10	50	10'	30.5'	18'
Executive Suite	748	40	25	50	50	25	70	10'	30.5'	24.5'
Diplomat Suite	748	40	25	50	50	25	70	10'	30.5'	24.5'

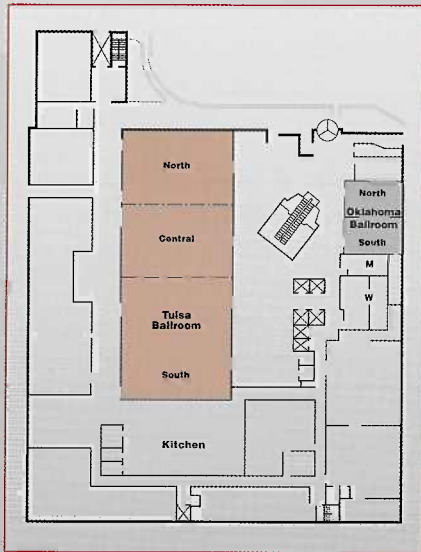

First Floor
(Concourse Level)

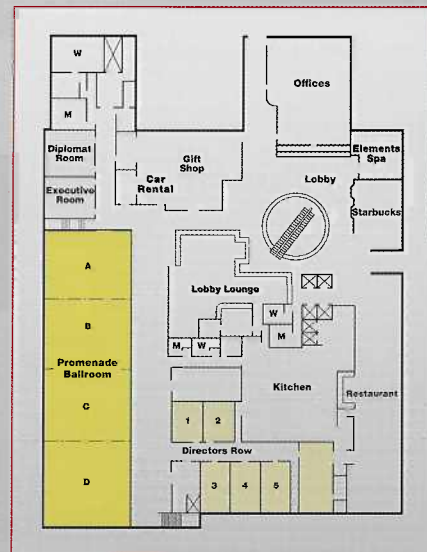

Second Floor
(Lobby Level)



CROWNE PLAZA[®]

TULSA

THE PLACE TO MEET.

100 E 2nd Street, Tulsa, OK 74103
 p 918-582-9000 f 918-560-2232
 cptulsa.com